

MATTAMY HOMES

AMIRA - BAILEYS RUN

BLUEPRINT DATE: 01.22.20

PACKAGE 2 and 3 - STANDARD KITCHEN
36" HIGH

- 03-11-20 AQO
- 03.18.20 CLH
- 09.03.20 CLH
- 09.24.20 CLH
- 07-10-23 DKB (BP 05-10-23)
- 10-05-23 DKB (BP 08-25-23)

OPT. DECORATIVE PACKAGE:

*****NOT AVAILABLE ON PACKAGE 2 *****

PERIMETER PANELS AND DECO DOORS:

- 1 - BEP34 (SIDE PANELS)
- 1 - DMDB (DECO DOORS)
- 3 - WEP42 (SIDE PANELS)
- 3 - DMDW36 (DECO DOORS)
- ISLAND PANELS AND DECO DOORS:
- 4 - DR1330 BUTT ND (SIDE DECO DOORS)
- 4 - DR1930 ND (BACK DECO DOORS)
- 2 - OGP8 (FURNITURE BASE)
- 1 - FP9634 (BACK PANEL)
- 2 - FP4834 (SIDE PANELS)
- 1 - UF3 (FILLER)
- 1 - OCM8 BLD (OUTSIDE CORNER)
- LIGHT RAIL:
- 3 - SBM8 (LIGHT RAIL)

OPT. CONVENIENCE PACKAGE:

- ① - B36 1TD BUTT CCBPPO ILO OF B36 1TD BUTT
- ALL OTHER BASE CABINETS
- ADD SS2 (DOUBLE SLIDING SHELVES)

OPT. FARM SINK

- 1 - DSB36 BUTT ILO SB36 BUTT
- 2 - HWC2X4X96 (CLEATS)

OPT. ENHANCED CONSTRUCTION PACKAGE:

- *****NOT AVAILABLE ON PACKAGE 2*****
- * CUSHION CLOSE FULL EXTENSION
- DOVETAILED DRAWERS AND SLIDING TRAYS
- * CUSHION CLOSE DOORS

PERIMETER:

- 4 - SM8 BLD (SCRIBE)
- 1 - UF3 (FILLER)
- 1 - UF6 (FILLER)
- 1 - UF642 (FILLER)
- 1 - DWR3 (DW PANEL)
- 2 - BTK8 PRT (TOEKICK)
- 1 - S3S696 (FILLER ABOVE MICRO CAB)
- 5 - CM8 BLD (CROWN)
- 5 - HWC 1X2X94 (CROWN CLEATS)
- 3 - SHM8 BLD (SHOE - DEL ONLY)

- 29 - HARDWARE
- DOORS - 21
- DRAWERS - 8

ISLAND:

- 2 - CS12 (BRACKETS)
- 1 - BTK8 PRT (TOEKICK)
- 1 - SM8 BLD (SCRIBE)
- 3 - SHM8 BLD (SHOE - DEL ONLY)

- 10 - HARDWARE:
- DOORS - 6
- DRAWERS - 4

DRAWERS 27" OR WIDER GET TWO PIECES OF HARDWARE

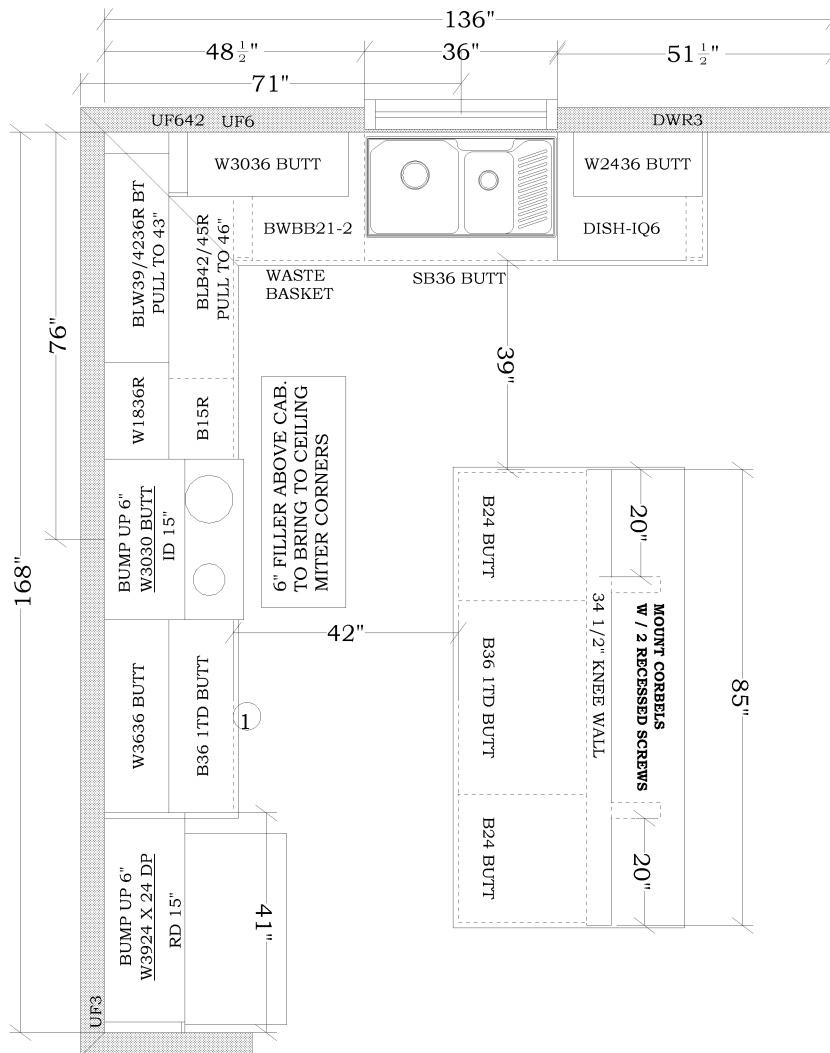

<p>This drawing is being provided as a courtesy to you. Cabinetry measurements contained here are considered to be accurate but will need to be field verified prior to placing order.</p>	<p>TIMBERLAKE CABINETS</p>	<p>American Woodmark Corporation assumes no liability in the use of these dimensions for the manufacture of any product not provided by AWC. Designer: D.Barber</p>	<p>Designed: 10/5/2023 Printed: 10/5/2023</p>
<p>D - MATTAMY HOMES - AMIRA - BAILEYS RUN - PKG 2 and 3 - STANDARD - All</p>		<p>Drawing #: 1 No Scale.</p>	

MATTAMY CHARLOTTE
AMIRA - BAILEYS RUN
PACKAGE 2 and 3 - STANDARD KITCHEN
36" HIGH

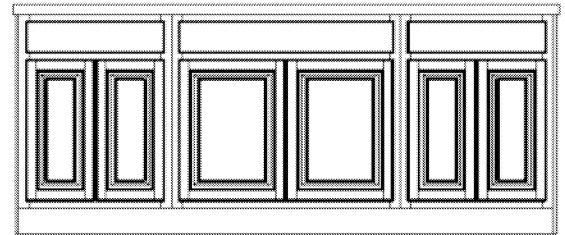
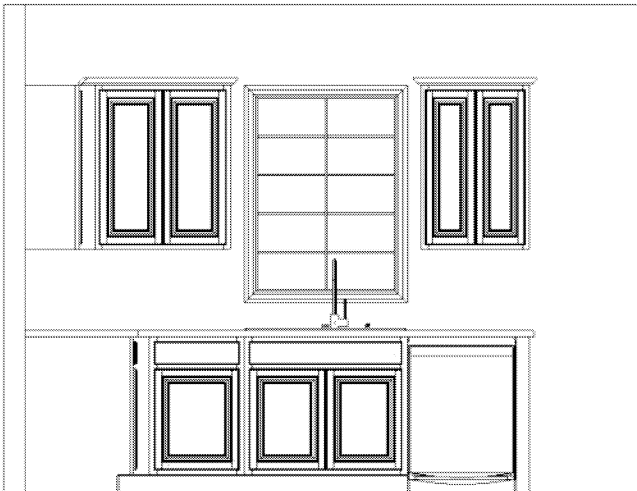
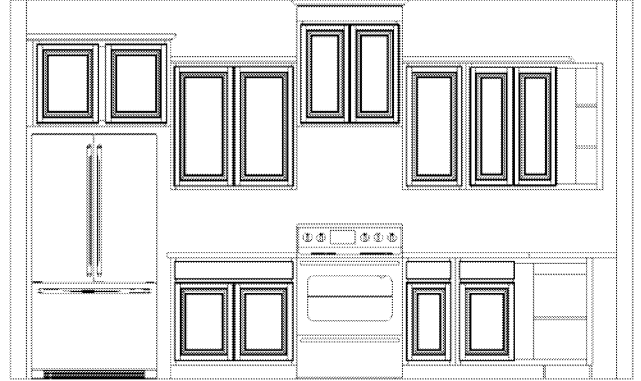
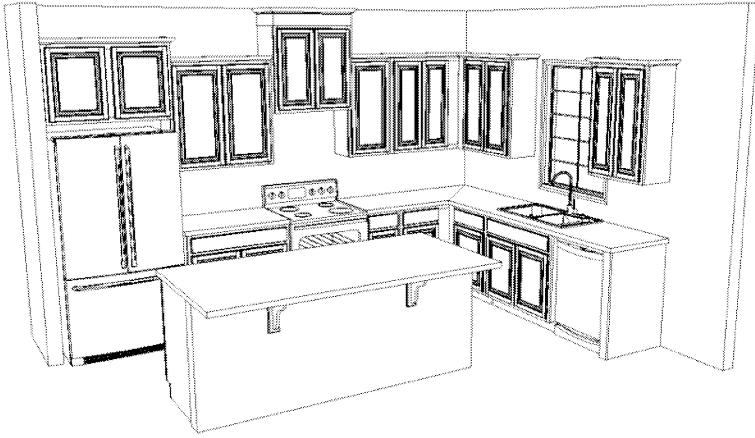

Note: This drawing is an artistic interpretation of the general appearance of the design. It is not meant to be an exact rendition.

Designed :10/5/2023
 Printed: 10/5/2023

TIMBERLAKE
 CABINETS

MATTAMY HOMES
AMIRA - BAILEYS RUN
 BLUEPRINT DATE: 01/22/20
 BATH VANITIES

03-11-20 AQO
 03.18.20 CLH
 09.23.20 CLH
 07-11-23 DKB
 10-05-23 DKB

OWNER'S BATH
 (2ND FLOOR):

- 1 - SM8 BLD
- 1 - BTK8 PRT
- 1 - SHM8 BLD (DEL ONLY)

- 7 - OPT. HARDWARE
- DOORS - 4
- DRAWERS - 3

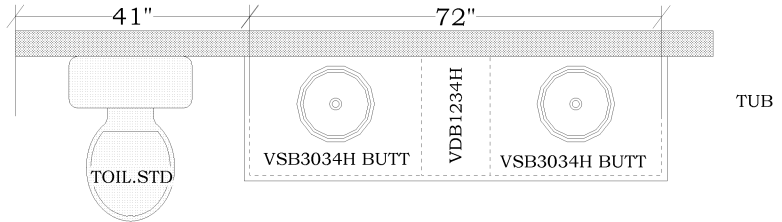

BATH 2

(2ND FLOOR):

- 1 - UF3
- 1 - SM8 BLD
- 1 - BTK8 PRT
- 1 - SHM8 BLD (DEL ONLY)

- 4 - OPT. HARDWARE:
- DOORS - 2
- DRAWERS - 2

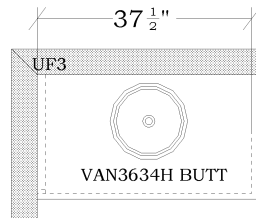

OPT. OWNER'S BATH
 (SUPER SHOWER W/SEAT)
 (2ND FLOOR): OPTIONAL

- 1 - UF3
- 1 - SM8 BLD
- 1 - BTK8 PRT
- 1 - SHM8 BLD (DEL ONLY)

- 7 - OPT. HARDWARE:
- DOORS - 4
- DRAWERS - 3

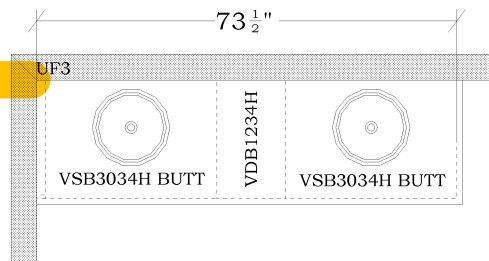

<p>This drawing is being provided as a courtesy to you. Cabinetry measurements contained here are considered to be accurate but will need to be field verified prior to placing order.</p>	<p>TIMBERLAKE CABINETS</p>	<p>American Woodmark Corporation assumes no liability in the use of these dimensions for the manufacture of any product not provided by AWC. Designer: D.Barber</p>	<p>Designed: 10/5/2023 Printed: 10/5/2023</p>
<p>D - MATTAMY HOMES - AMIRA - BAILEYS RUN - VANITIES (10-05-23))</p>		<p>All</p>	<p>Drawing #: 1 No Scale.</p>

OWNERS BATH

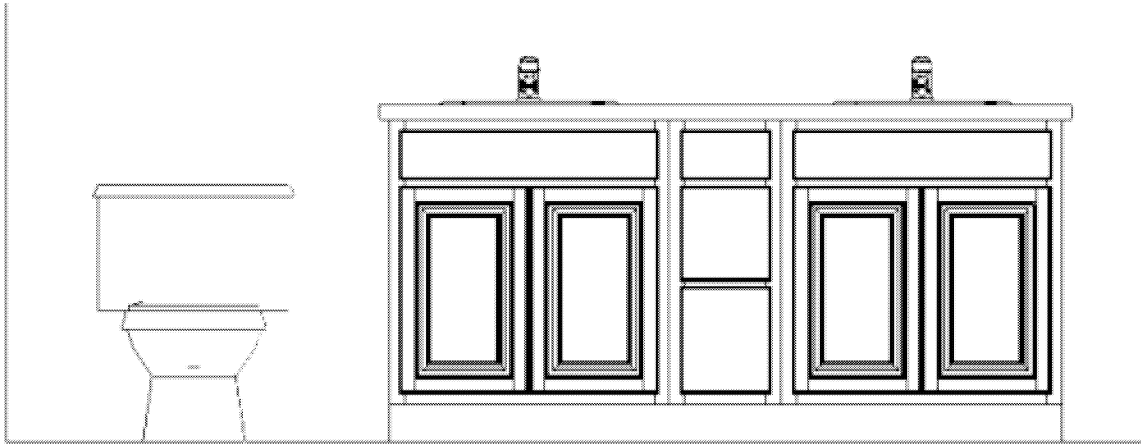

BATH 2

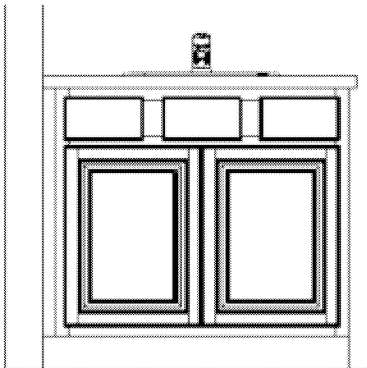

OPT. OWNERS BATH

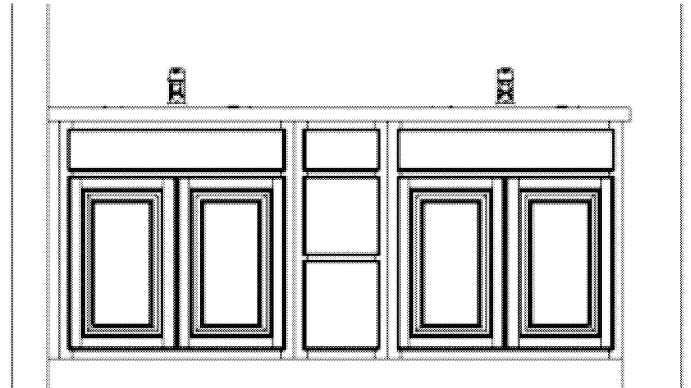

Note: This drawing is an artistic interpretation of the general appearance of the design. It is not meant to be an exact rendition.

TIMBERLAKE
CABINETS

Designed :10/5/2023
Printed: 10/5/2023