

MATTAMY HOMES

**AMIRA - BAILEYS RUN**

BLUEPRINT DATE: 01.22.20

**PACKAGE 2 and 3 - STANDARD KITCHEN**  
36" HIGH

- 03-11-20 AQO
- 03.18.20 CLH
- 09.03.20 CLH
- 09.24.20 CLH
- 07-10-23 DKB ( BP 05-10-23 )
- 10-05-23 DKB ( BP 08-25-23 )

OPT. DECORATIVE PACKAGE:

\*\*\*\*\*NOT AVAILABLE ON PACKAGE 2 \*\*\*\*\*

PERIMETER PANELS AND DECO DOORS:

- 1 - BEP34 ( SIDE PANELS )
- 1 - DMDB ( DECO DOORS )
- 3 - WEP42 ( SIDE PANELS )
- 3 - DMDW36 ( DECO DOORS )
- ISLAND PANELS AND DECO DOORS:
- 4 - DR1330 BUTT ND ( SIDE DECO DOORS )
- 4 - DR1930 ND ( BACK DECO DOORS )
- 2 - OGP8 ( FURNITURE BASE )
- 1 - FP9634 ( BACK PANEL )
- 2 - FP4834 ( SIDE PANELS )
- 1 - UF3 ( FILLER )
- 1 - OCM8 BLD ( OUTSIDE CORNER )
- LIGHT RAIL:
- 3 - SBM8 ( LIGHT RAIL )

OPT. CONVENIENCE PACKAGE:

- ① - B36 1TD BUTT CCBPPO ILO OF B36 1TD BUTT
- ALL OTHER BASE CABINETS
- ADD SS2 ( DOUBLE SLIDING SHELVES )

OPT. FARM SINK

- 1 - DSB36 BUTT ILO SB36 BUTT
- 2 - HWC2X4X96 ( CLEATS )

OPT. ENHANCED CONSTRUCTION PACKAGE:

\*\*\*\*\*NOT AVAILABLE ON PACKAGE 2\*\*\*\*\*

- \* CUSHION CLOSE FULL EXTENSION
- DOVETAILED DRAWERS AND SLIDING TRAYS
- \* CUSHION CLOSE DOORS

PERIMETER:

- 4 - SM8 BLD ( SCRIBE )
- 1 - UF3 ( FILLER )
- 1 - UF6 ( FILLER )
- 1 - UF642 ( FILLER )
- 1 - DWR3 ( DW PANEL )
- 2 - BTK8 PRT ( TOEKICK )
- 1 - S3S696 ( FILLER ABOVE MICRO CAB )
- 5 - CM8 BLD ( CROWN )
- 5 - HWC 1X2X94 ( CROWN CLEATS )
- 3 - SHM8 BLD ( SHOE - DEL ONLY )

- 29 - HARDWARE
- DOORS - 21
- DRAWERS - 8

ISLAND:

- 2 - CS12 ( BRACKETS )
- 1 - BTK8 PRT ( TOEKICK )
- 1 - SM8 BLD ( SCRIBE )
- 3 - SHM8 BLD ( SHOE - DEL ONLY )

- 10 - HARDWARE:
- DOORS - 6
- DRAWERS - 4

DRAWERS 27" OR WIDER GET TWO PIECES OF HARDWARE

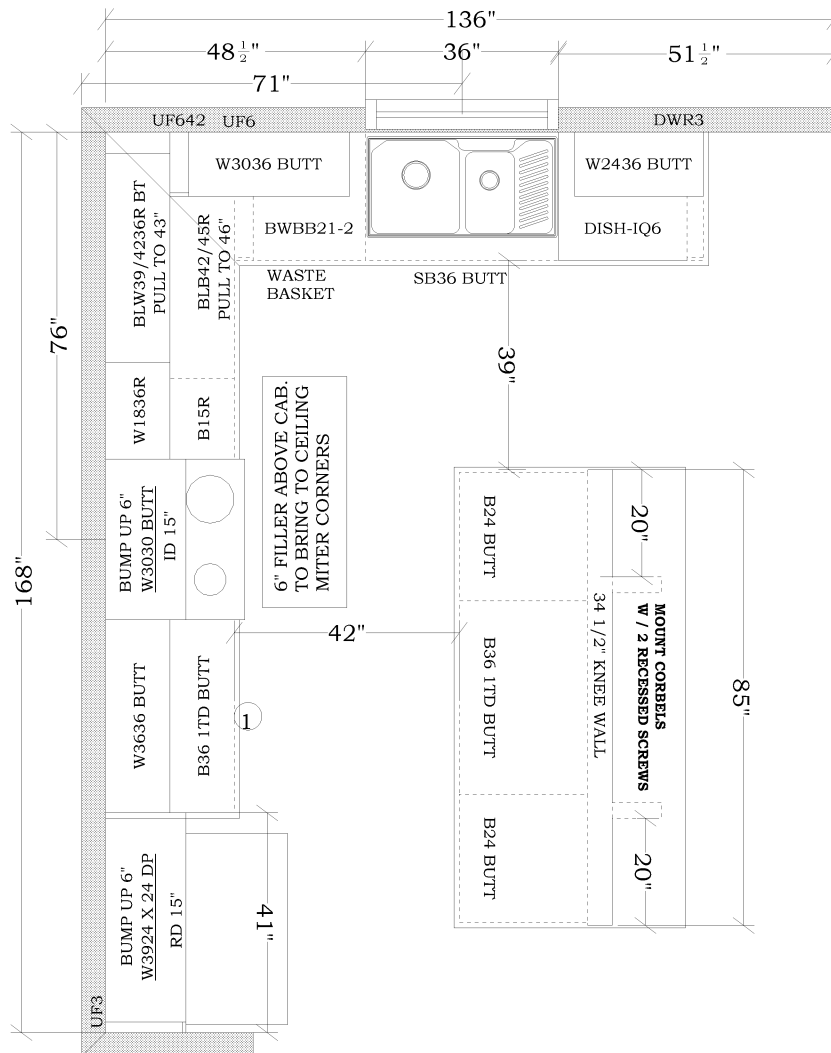

<p>This drawing is being provided as a courtesy to you. Cabinetry measurements contained here are considered to be accurate but will need to be field verified prior to placing order.</p>	<p><b>TIMBERLAKE</b> CABINETS</p>	<p>American Woodmark Corporation assumes no liability in the use of these dimensions for the manufacture of any product not provided by AWC. Designer: D.Barber</p>	<p>Designed: 10/5/2023 Printed: 10/5/2023</p>
<p>D - MATTAMY HOMES - AMIRA - BAILEYS RUN - PKG 2 and 3 - STANDARD - All</p>		<p>Drawing #: 1   No Scale.</p>	

MATTAMY CHARLOTTE  
**AMIRA - BAILEYS RUN**  
**PACKAGE 2 and 3 - STANDARD KITCHEN**  
**36" HIGH**

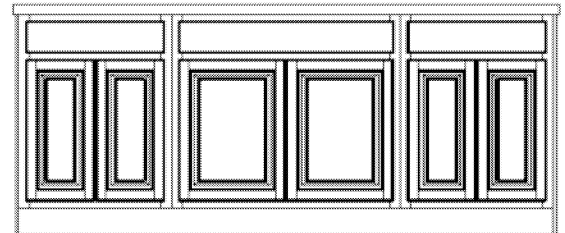
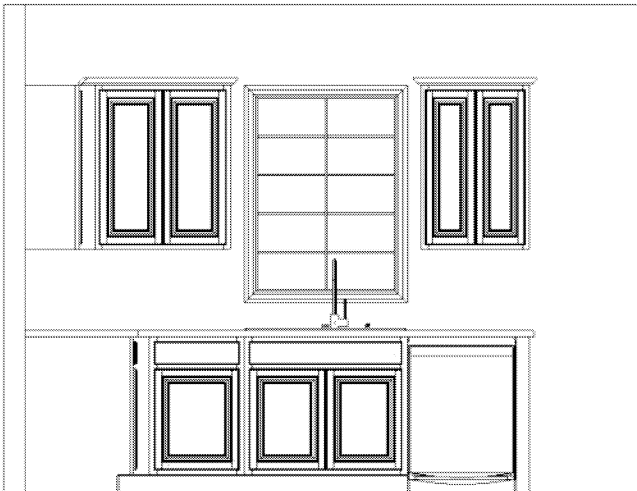
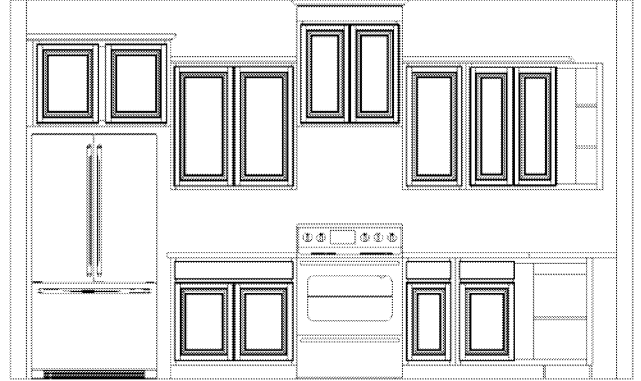
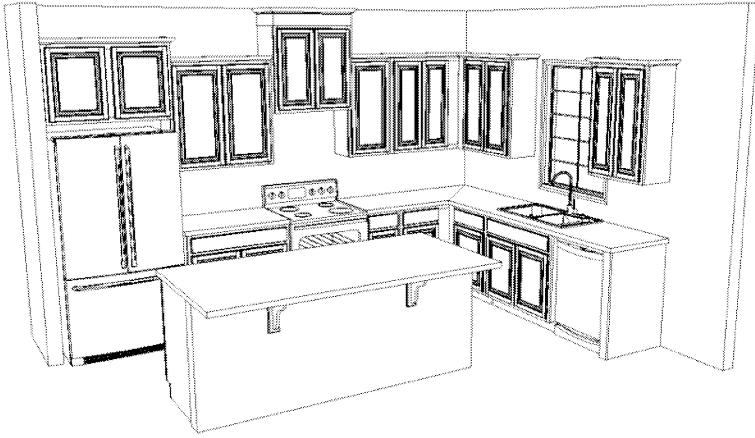

Note: This drawing is an artistic interpretation of the general appearance of the design. It is not meant to be an exact rendition.

Designed :10/5/2023  
 Printed: 10/5/2023

**TIMBERLAKE**  
 CABINETS

MATTAMY HOMES  
**AMIRA - BAILEYS RUN**  
 BLUEPRINT DATE: 01/22/20  
 BATH VANITIES

03-11-20 AQO  
 03.18.20 CLH  
 09.23.20 CLH  
 07-11-23 DKB  
 10-05-23 DKB

OWNER'S BATH  
 (2ND FLOOR):

- 1 - SM8 BLD
- 1 - BTK8 PRT
- 1 - SHM8 BLD (DEL ONLY)
  
- 7 - OPT. HARDWARE
- DOORS - 4
- DRAWERS - 3

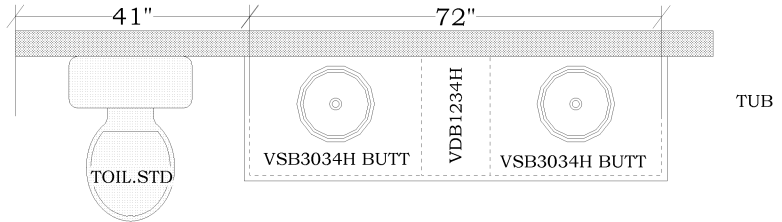

**BATH 2**

(2ND FLOOR):

- 1 - UF3
- 1 - SM8 BLD
- 1 - BTK8 PRT
- 1 - SHM8 BLD (DEL ONLY)
  
- 4 - OPT. HARDWARE:
- DOORS - 2
- DRAWERS - 2

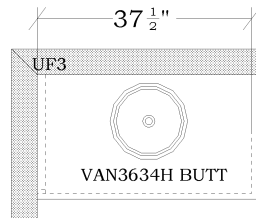

**OPT. OWNER'S BATH**  
 (SUPER SHOWER W/SEAT)  
 (2ND FLOOR): OPTIONAL

- 1 - UF3
- 1 - SM8 BLD
- 1 - BTK8 PRT
- 1 - SHM8 BLD (DEL ONLY)
  
- 7 - OPT. HARDWARE:
- DOORS - 4
- DRAWERS - 3

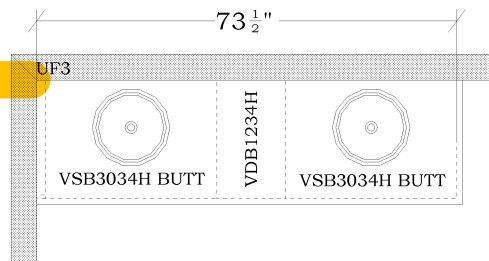

<p>This drawing is being provided as a courtesy to you. Cabinetry measurements contained here are considered to be accurate but will need to be field verified prior to placing order.</p>	<p><b>TIMBERLAKE</b> CABINETS</p>	<p>American Woodmark Corporation assumes no liability in the use of these dimensions for the manufacture of any product not provided by AWC.          Designer: D.Barber</p>	<p>Designed: 10/5/2023          Printed: 10/5/2023</p>
<p>D - MATTAMY HOMES - AMIRA - BAILEYS RUN - VANITIES (10-05-23))</p>		<p>All</p>	<p>Drawing #: 1   No Scale.</p>

# OWNERS BATH

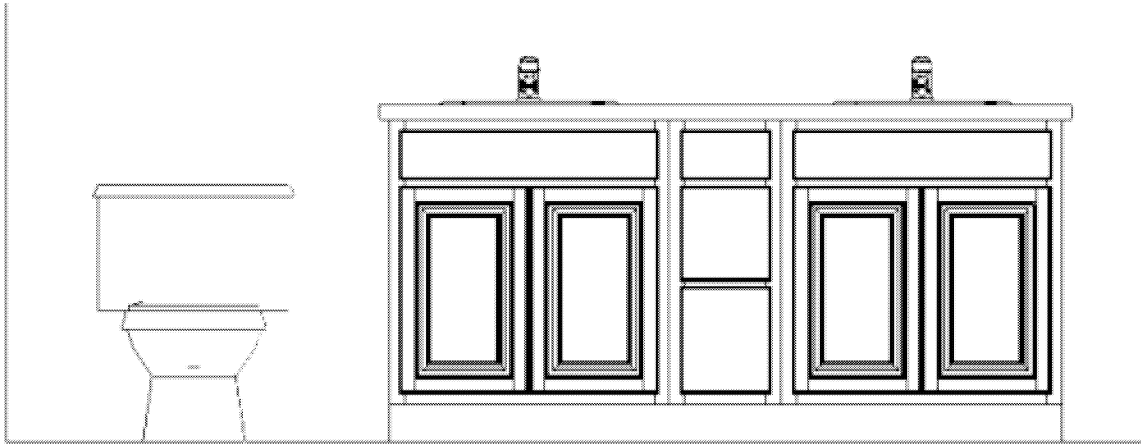

## BATH 2

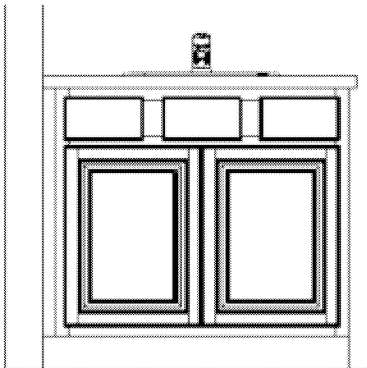

## OPT. OWNERS BATH

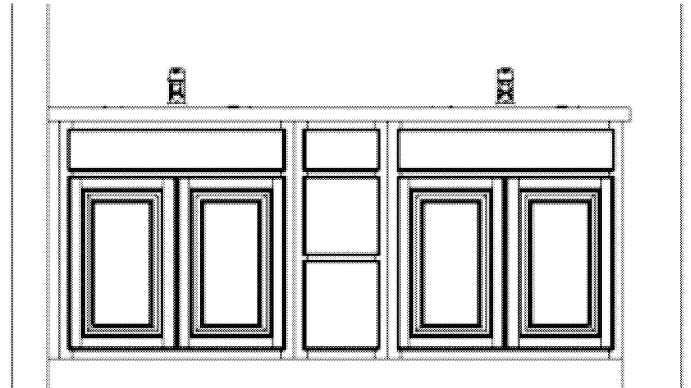

Note: This drawing is an artistic interpretation of the general appearance of the design. It is not meant to be an exact rendition.

**TIMBERLAKE**  
CABINETS

Designed :10/5/2023  
Printed: 10/5/2023