

MATTAMY HOMES

AMIRA - BAILEYS RUN -

BLUEPRINT DATE: 01.22.20

PACKAGE 2 and 3 - STANDARD KITCHEN
36" HIGH

03-11-20 AQO

03.18.20 CLH

09.03.20 CLH

09.24.20 CLH

07-10-23 DKB (BP 05-10-23)

10-05-23 DKB (BP 08-25-23)

OPT. DECORATIVE PACKAGE:

*****NOT AVAILABLE ON PACKAGE 2 *****

PERIMETER PANELS AND DECO DOORS:

1 - BEP34 (SIDE PANELS)

1 - DMDB (DECO DOORS)

3 - WEP42 (SIDE PANELS)

3 - DMDW36 (DECO DOORS)

ISLAND PANELS AND DECO DOORS:

4 - DR1330 BUTT ND (SIDE DECO DOORS)

4 - DR1930 ND (BACK DECO DOORS)

2 - OGP8 (FURNITURE BASE)

1 - FP9634 (BACK PANEL)

2 - FP4834 (SIDE PANELS)

1 - UF3 (FILLER)

1 - OCM8 BLD (OUTSIDE CORNER)

LIGHT RAIL:

3 - SBM8 (LIGHT RAIL)

OPT. CONVENIENCE PACKAGE:

1 - B36 1TD BUTT CCBPPO ILO OF B36 1TD BUTT

ALL OTHER BASE CABINETS

ADD SS2 (DOUBLE SLIDING SHELVES)

OPT. FARM SINK

1 - DSB36 BUTT ILO SB36 BUTT

2 - HWC2X4X96 (CLEATS)

OPT. ENHANCED CONSTRUCTION PACKAGE:

*****NOT AVAILABLE ON PACKAGE 2*****

* CUSHION CLOSE FULL EXTENSION

DOVETAILED DRAWERS AND SLIDING TRAYS

* CUSHION CLOSE DOORS

PERIMETER:

4 - SM8 BLD (SCRIBE)

1 - UF3 (FILLER)

1 - UF6 (FILLER)

1 - UF642 (FILLER)

1 - DWR3 (DW PANEL)

2 - BTK8 PRT (TOEKICK)

1 - S3S696 (FILLER ABOVE MICRO CAB)

5 - CM8 BLD (CROWN)

5 - HWC 1X2X94 (CROWN CLEATS)

3 - SHM8 BLD (SHOE - DEL ONLY)

29 - HARDWARE

DOORS - 21

DRAWERS - 8

ISLAND:

2 - CS12 (BRACKETS)

1 - BTK8 PRT (TOEKICK)

1 - SM8 BLD (SCRIBE)

3 - SHM8 BLD (SHOE - DEL ONLY)

10 - HARDWARE:

DOORS - 6

DRAWERS - 4

DRAWERS 27" OR WIDER GET

TWO PIECES OF HARDWARE

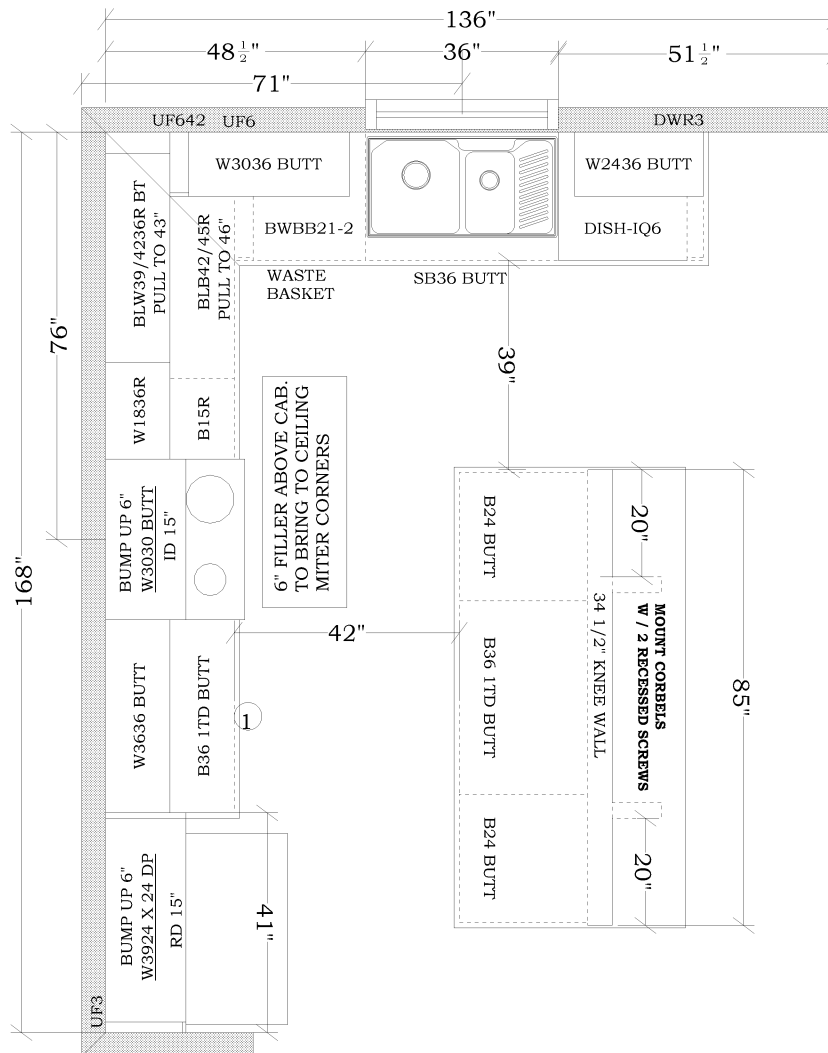

This drawing is being provided as a courtesy to you. Cabinetry measurements contained here are considered to be accurate but will need to be field verified prior to placing order.

TIMBERLAKE
CABINETS

American Woodmark Corporation assumes no liability in the use of these dimensions for the manufacture of any product not provided by AWC. Designer: D.Barber

Designed: 10/5/2023
Printed: 10/5/2023

MATTAMY CHARLOTTE
 AMIRA - BAILEYS RUN -
 PACKAGE 2 and 3 - STANDARD KITCHEN
 36" HIGH

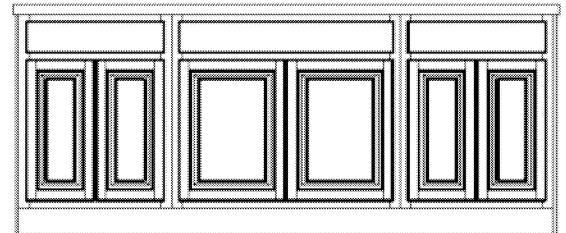
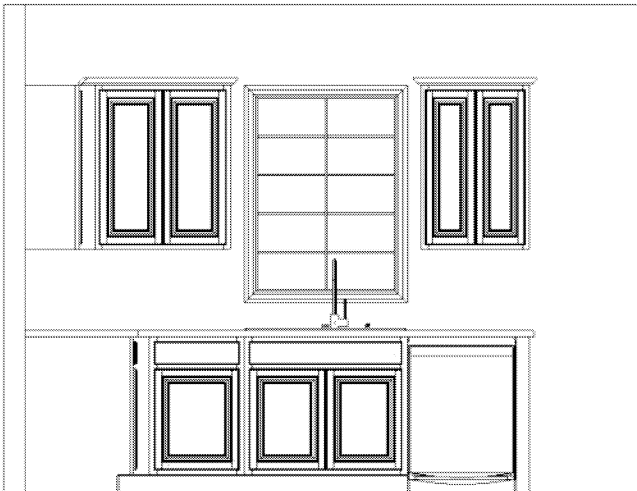
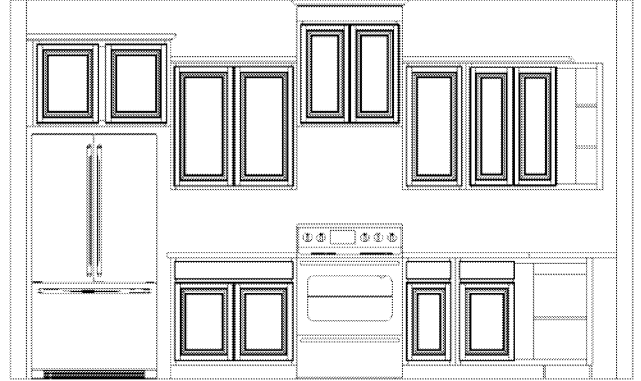
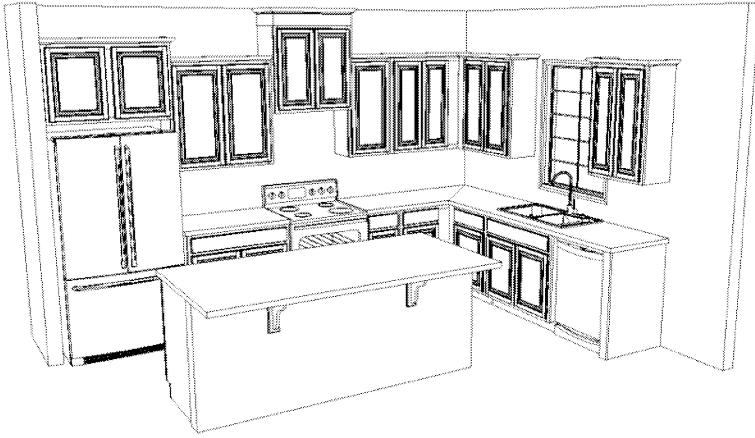

Note: This drawing is an artistic interpretation of the general appearance of the design. It is not meant to be an exact rendition.

TIMBERLAKE
 CABINETS

Designed :10/5/2023
 Printed: 10/5/2023

MATTAMY HOMES
 AMIRA - ~~BAILEYS RUN~~
 BLUEPRINT DATE: 01/22/20
 BATH VANITIES

03-11-20 AQO
 03.18.20 CLH
 09.23.20 CLH
 07-11-23 DKB
 10-05-23 DKB

OWNER'S BATH
 (2ND FLOOR):

- 1 - SM8 BLD
- 1 - BTK8 PRT
- 1 - SHM8 BLD (DEL ONLY)

- 7 - OPT. HARDWARE
- DOORS - 4
- DRAWERS - 3

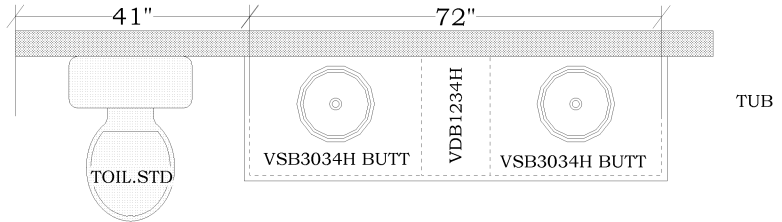

BATH 2

(2ND FLOOR):

- 1 - UF3
- 1 - SM8 BLD
- 1 - BTK8 PRT
- 1 - SHM8 BLD (DEL ONLY)

- 4 - OPT. HARDWARE:
- DOORS - 2
- DRAWERS - 2

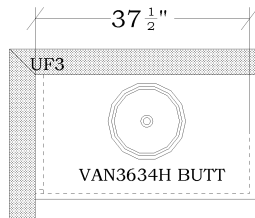

OPT. OWNER'S BATH
 (SUPER SHOWER W/SEAT)
 (2ND FLOOR): OPTIONAL

- 1 - UF3
- 1 - SM8 BLD
- 1 - BTK8 PRT
- 1 - SHM8 BLD (DEL ONLY)

- 7 - OPT. HARDWARE:
- DOORS - 4
- DRAWERS - 3

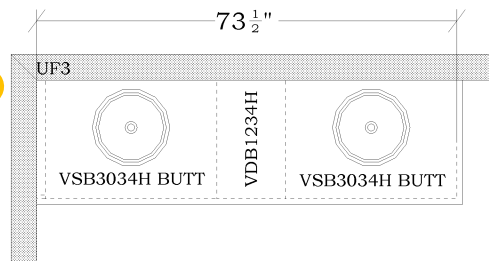

<p>This drawing is being provided as a courtesy to you. Cabinetry measurements contained here are considered to be accurate but will need to be field verified prior to placing order.</p>	<p>TIMBERLAKE CABINETS</p>	<p>American Woodmark Corporation assumes no liability in the use of these dimensions for the manufacture of any product not provided by AWC. Designer: D.Barber</p>	<p>Designed: 10/5/2023 Printed: 10/5/2023</p>
<p>D - MATTAMY HOMES - AMIRA - BAILEYS RUN - VANITIES (10-05-23))</p>		<p>All</p>	<p>Drawing #: 1 No Scale.</p>

OWNERS BATH

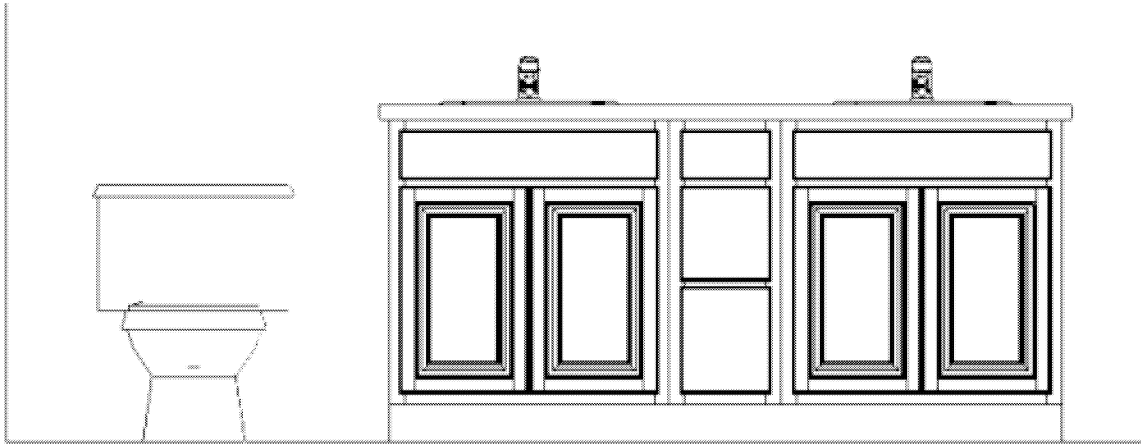

BATH 2

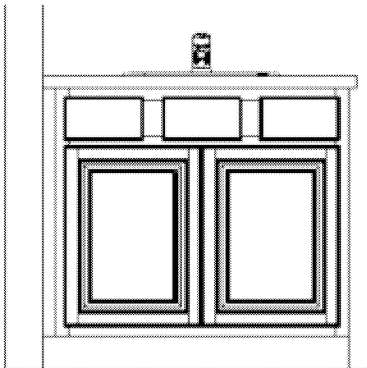

OPT. OWNERS BATH

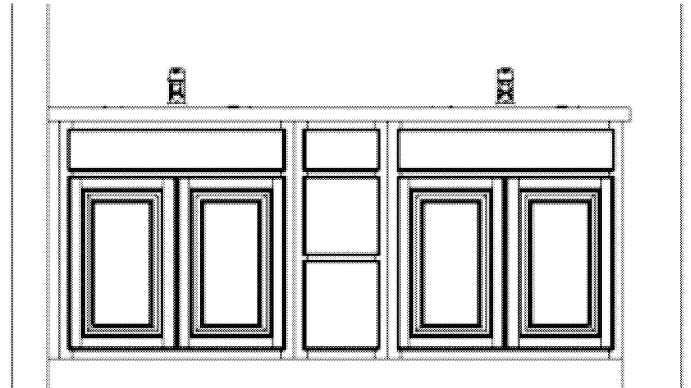

Note: This drawing is an artistic interpretation of the general appearance of the design. It is not meant to be an exact rendition.

TIMBERLAKE
CABINETS

Designed :10/5/2023
Printed: 10/5/2023